

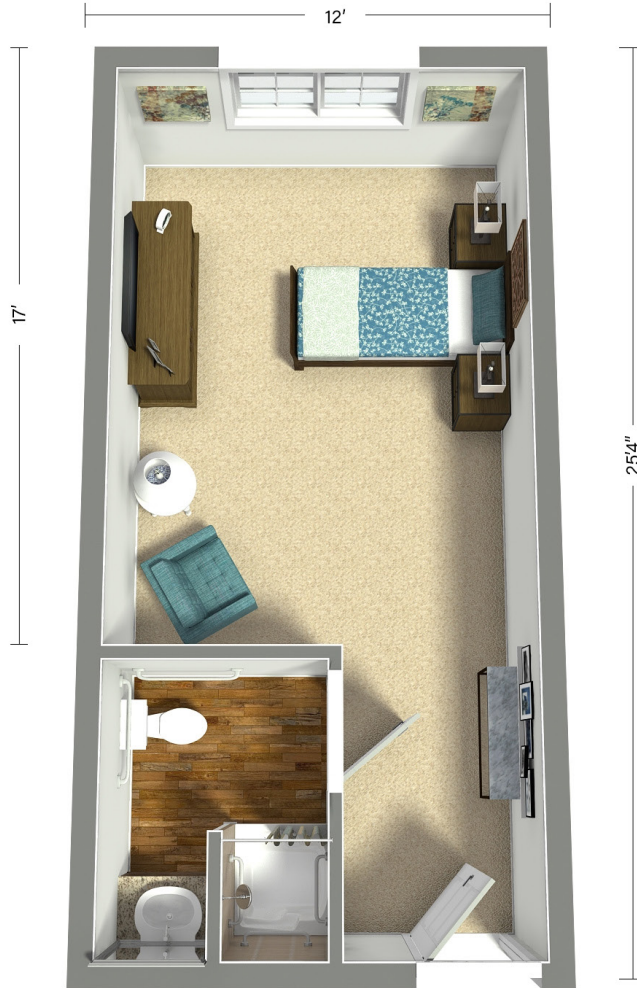

MEMORY CARE

# Floor Plans



## Private Suite | 304 sq. ft.

Approx. Sq. ft., Pricing Based on Availability

Rate: \_\_\_\_\_

Apt. #: \_\_\_\_\_

SCAN TO  
LEARN MORE



INDEPENDENT LIVING | ASSISTED LIVING | MEMORY CARE

13150 Four Star Blvd, Austin, TX 78737 | 512-883-6144 | LedgestoneSL.com

Facility ID # 106696